

Stubshafts

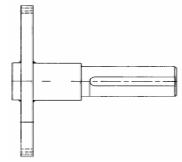

Stubshaft drive plates to suit SAE flywheels.

Stub shafts are manufactured from high tensile steel bar and steel plate. The stub is machined press fit into the backing plate, butt welded.

Part Number	Size	Shaft Size	Power	Plate O.D	PCD	Shaft length	Key Size
PTOSHAFT06.5	SAE 6.5	1-5/8"	60 hp	8-1/2"	7-7/8"	110mm	7/16"
PTOSHAFT06.5X1●	SAE 6.5	1"		8-1/2"	7-7/8"		
PTOSHAFT06.5X2●	SAE 6.5	2"		8-1/2"	7-7/8"		
PTO SHAFT07.5	SAE 7.5	1-5/8"	60 hp	9-1/2"	8-3/4"	110mm	7/16"
PTOSHAFT07.5X2●	SAE 7.5	2"		9-1/2"	8-3/4"		
PTOSHAFT08●	SAE 8	1-5/8"	80 hp	10-3/8"	9-5/8"	110mm	7/16"
PTOSHAFT08C●	SAE 8	2"		10-3/8"	9-5/8"		
PTOSHAFT08MF●	SAE 8	1-5/8 "		10-3/8"	9-5/8"	220mm	
PTOSHAFT10	SAE 10	1-5/8"	100 hp	12-3/8"	11-5/8"	110mm	7/16"
PTOSHAFT10C	SAE 10	2"	160 hp	12-3/8"	11-5/8"	110mm	1/2"
PTOSHAFT10MF	SAE 10	2"	160 hp	12-3/8"	11-5/8"	220mm	
PTOSHAFT11	SAE 11.5	2"	160 hp	13-7/8"	13-1/8"	110mm	1/2"
PTOSHAFT11C●	SAE 11.5	2-1/2"	200 hp	13-7/8"	13-1/8"		
PTOSHAFT11MF	SAE 11.5	2"	160 hp	13-7/8"	13-1/8"	220mm	
PTOSHAFT14●	SAE 14	2-3/4"		18-3/8"	17-1/4"	190mm	3/4"
PTOSHAFT14C	SAE 14	3-1/2"	450 hp	18-3/8"	17-1/4"	190mm	7/8"
PTOSHAFT14CHD●	SAE 14	3-1/2"	600 hp	18-3/8"	17-1/4"		
PTOSHAFT14CHD4	SAE 14	4"	800 hp	18-3/8"	17-1/4"		
PTOSHAFT14X3●	SAE 14	3"	300 hp	18-3/8"	17-1/4"		
PTOSHAFT18●	SAE 18	4"	800 hp				
PTOSHAFT18CHD4●	SAE 18	4"	1000 hp				
PTOSHAFT18CHD4.5●	SAE 18	4-1/2"	1500 hp				

- Made to order – allow 2 to 3 weeks to manufacture. Faster delivery is possible if required. Other sizes manufactured on request

Specialty Subshafts

Part Number	Shaft Size	Power
Kubota ERH40	30mm	10 hp
Kubota RK60 to RK125	30mm	20 hp
Kubota ER Series	46mm	30 hp
Kubota Super Mini	1"	20 hp
Kubota 05EC	40mm	40 hp
Kubota 03EC	40mm	60 hp

